



MONTANA FISH, WILDLIFE & PARKS

PO Box 200701 Helena, MT 59620-0701
(406) 444-9947

ENVIRONMENTAL ASSESSMENT CHECKLIST- AMMEDED, September 7, 2021

PART I. PURPOSE OF AND NEED FOR ACTION

1. Project Title: Henneberry Fishing Access Site Proposed Improvements

This document serves as an amendment to the original Environmental Assessment Checklist completed in March 2019. Continued discussion with outfitters, guides and the general public revealed design comments not brought forward in the initial public comment period. After careful consideration of the previous design by all parties, it was agreed the further improvements should be made to anticipate the growing demands on the Beaverhead River. This document serves to identify these design changes in compliance with Section 23-1-110, MCA.

2. Type of Proposed Action:

Montana Fish, Wildlife & Parks (FWP) proposes to construct additional parking facilities, improve boat-launching facilities, and improve the handicap accessibility at Henneberry Fishing Access Site (FAS) in order to accommodate the increasing popularity and use of the site.

3. Location Affected by Proposed Action:

Henneberry FAS is located on two parcels totaling 642 acres approximately 16 miles south of Dillon, Montana and 5 miles north of Clark Canyon Reservoir along Interstate 15 and off High Bridge Road, NW1/4 of Section 15 Township 9 South Range 10 West.

Figure 1 – General Location of Henneberry FAS, Dillon, Montana

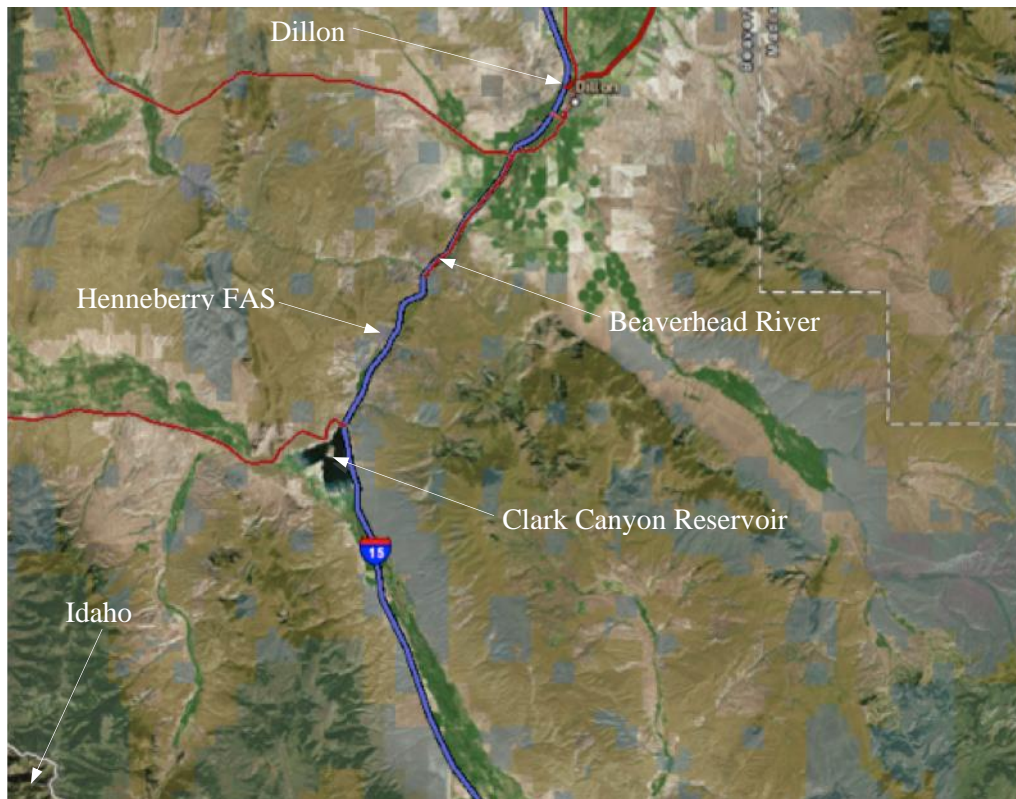

4. Agency Authority for the Proposed Action:

The 1977 Montana Legislature enacted Section 87-1-605, Montana Code Annotated (MCA), which directs FWP to acquire, develop, and operate a system of fishing accesses. The legislature earmarked a funding account to ensure that the fishing access site program would be implemented. Section 87-1-303, MCA, authorizes the collection of fees and charges for the use of fishing access sites, and contains rule-making authority for their use, occupancy, and protection. Furthermore, Section 23-1-110, MCA, and Administrative Rules of Montana (ARM) 12.2.433 guide public involvement and comment for improvements at state parks and fishing access sites, which this document provides.

ARM 12.8.602 requires the Department to consider the wishes of the public, the capacity of the site for development, environmental impacts, long-range maintenance, protection of natural features and impacts on tourism as these elements relate to development or improvement to fishing access sites or state parks. This document will illuminate the facets of the Proposed Action in relation to this rule. See *Appendix A* for HB 495 qualification.

5. Need for the Action(s):

Henneberry FAS, located on the Beaverhead River approximately 16 miles south of Dillon, Montana, was acquired in fee title in 1977. Existing facilities on the northern parcel of the FAS includes a singlewide gravel boat ramp; parking area; concrete vault latrine; boat staging area, and approximately one-third mile of Henneberry Road, a county road, crosses the FAS. A pioneered boat ramp and staging loop road are located about 150 feet upstream of the gravel boat ramp, and a primitive parking area and a primitive camping area are located approximately ½ mile north of the FAS facilities west of the Beaverhead River. A gravel parking area with a walking path to the river is located on the FAS southern parcel (see Figure 2).

Water-based recreation has become increasingly popular in Montana, resulting in an increased use of the Beaverhead River and Henneberry FAS for angling, floating, boating, kayaking, hunting, wildlife viewing, dog walking, and picnicking. As a result of the increased use, the parking area at Henneberry FAS is often full, causing visitors to park vehicles along the county road and creating congestion and a safety hazard. The proposed parking expansion would alleviate the vehicle congestion on the FAS and county road, particularly during high use times of the year. The existing FAS facilities are not ADA-accessible, and the construction of an ADA-accessible parking pad and sidewalk to the latrine would improve the ADA-accessibility of the FAS. The pioneered boat ramp often erodes increasing sediment delivery to the Beaverhead River. Improvement of the pioneered boat ramp would reduce bank erosion and sediment delivery to the river.

6. Objectives for the Action(s):

The objective of the proposed improvement project is to expand the parking facilities and improve the staging area roads, boat ramp, pioneered boat ramp, and ADA-accessibility of Henneberry FAS in order to accommodate increased current and future use of the popular and heavily used Henneberry FAS.

7. Project Size: estimate the number of acres that would be directly affected:

Based on public input, FWP is proposing that the new parking area be expanded in size from the original .25 acres to approximately .70 acres to accommodate growing use adjacent to the existing parking area and improvement of the staging area roads, boat ramps, latrine facilities, and existing parking area.

8. Affected Environment (A brief description of the affected area of the proposed project):

Henneberry FAS is located on two parcels totaling 642 acres and is owned in fee title by FWP, with the majority of facilities located on the north parcel. Approximately one third of the FAS is located within the Beaverhead River floodway with another third located within the 100-year floodplain. The remainder of the

FAS property is not located within the floodplain. Wetlands and riparian forests are located along the Beaverhead River and the Henneberry FAS facilities. *Temporarily Flooded Freshwater Scrub-Shrub Wetlands* (PSSA), *Temporarily Flooded Freshwater Emergent Wetland* (PEMA), and *Riparian Lotic Forest (Rp1FO)*, as defined by the Montana Natural Heritage Program (MNHP) Wetland Mapping Program, are located near the FAS facilities along the Beaverhead River. No wetland or riparian forest is located on the project site or would be disturbed during construction of the proposed parking area or proposed improvements. The primary upland Ecological Types on Henneberry FAS, as defined by the MNHP, are *Montane Sagebrush Steppe* and *Big Sagebrush Steppe* and are dominated by mountain big sagebrush, silver sagebrush, and various other sagebrushes. The primary riparian Ecological Types near the proposed project site are *Rocky Mountain Lower Montane-Foothill Riparian Woodland and Shrubland* and *Alpine-Montane Wet Meadow* and are dominated by narrowleaf cottonwood and various sedges. The site does not provide critical habitat for any wildlife or plant species. A search of the MNHP element occurrence database indicates occurrences of bald eagle (listed as DM by the US Fish and Wildlife Service (USFWS)) and peregrine falcon (listed as DM by USFWS) in the vicinity of the proposed project. No other occurrences of federally ranked, or considered for ranking, animal or plant species have been found within the vicinity of the proposed project. The search indicated that great blue heron, greater sage-grouse, Clark's nutcracker, golden eagle, ferruginous hawk, little brown myotis, and hoary bat, Montana animal Species of Concern, have been observed in or near the proposed project site. Though the USFWS identified grizzly bear, Canada lynx, and Ute ladies' tresses, (listed as LT by USFWS), wolverine (listed as P by USFWS), and white bark pine (listed as C by USFWS) as present in Beaverhead County, these species have not been observed in the vicinity of Henneberry FAS, and the FAS does not provide preferred habitat for these species.



Figure 2 - Henneberry FAS and WMA Parcel Map, Dillon, Montana

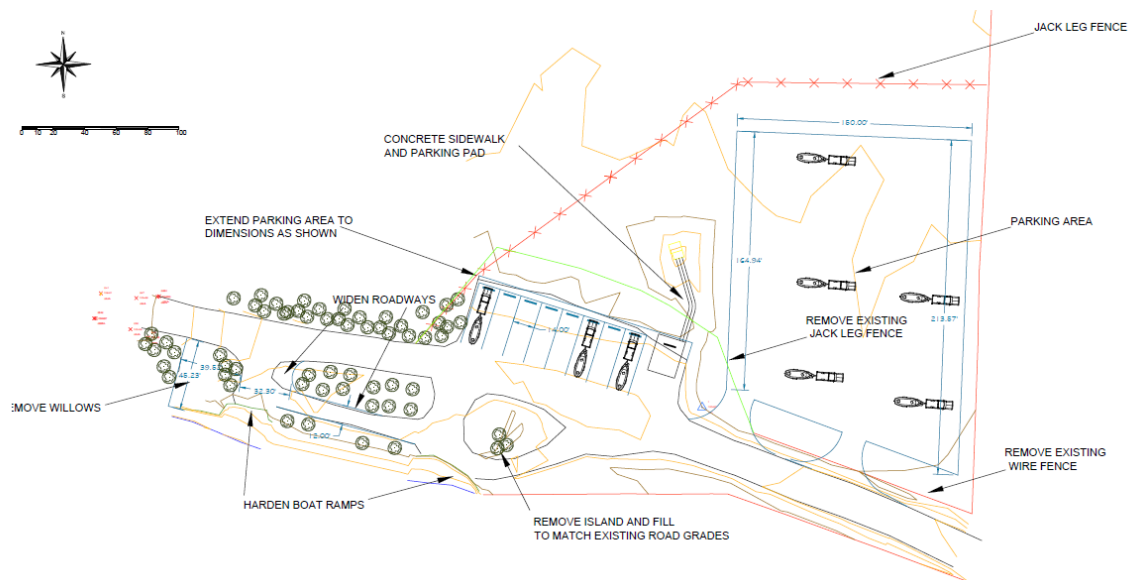

Figure 3 - Henneberry FAS Preliminary Concept Plan, Dillon, Montana

9. Description of Project:

FWP proposes to improve the Henneberry FAS including: Construction of an additional parking area of up to .70 acres. An ADA-compliant parking pad and sidewalk to the concrete vault latrine will be installed. Replacement of the existing jack-leg fence and installing additional jack-leg fencing around the new parking area. Improvements will also be made to the gravel staging area, main boat ramp and pioneered ramp. The small patch of willows near the pioneered boat ramp will be removed to provide a clear path for the backing of trailers. To provide for safer sight lines for road traffic, some willows also be removed between the existing boat ramp and the bridge. The memorial tree will be preserved. New internal informational and regulatory signage will also be installed

10. List any Other Local, State, or Federal Agency that has Overlapping or Additional Jurisdiction:

(a) **Permits:** Permits would be filed at least 2 weeks prior to project start.

<u>Agency Name</u>	<u>Permits</u>
Beaverhead County	Floodplain Permit and Sanitation Permit
Montana Dept. of Environmental Quality	318 Short Term Water Quality Standard for Turbidity
Montana Fish, Wildlife & Parks	124 Montana Stream Protection Act
U.DS. Army Corps of Engineers	404 Federal Clean Water Act

(b) **Funding:**

<u>Agency Name</u>	<u>Funding Amount</u>
Montana Fish, Wildlife & Parks Site Protection Fund	\$ 35,000

11. History of the Planning and Scoping Process, and Any Public Involvement:

The public would be notified in the following manners to comment on the Henneberry Fishing Access Site Proposed Improvement Project and the Proposed Action and alternatives:

- Two public notices in each of these papers: *the Dillon Tribune* and *the Helena Independent Record*.
- Public notice on the Fish, Wildlife & Parks web page: <http://fwp.mt.gov>.
- Draft EA's will be available at the FWP Region 3 Headquarters in Bozeman and the FWP State Headquarters in Helena.
- A news release will be prepared and distributed to a standard list of media outlets interested in FWP Region 3 issues.

This level of public notice and participation is appropriate for a project of this scope having limited impacts, many of which can be mitigated. If requested within the comment period, FWP will schedule and conduct a public meeting on this Proposed Action.

12. Duration of comment period:

The original 30 day public comment period was completed on April 29, 2019. The comment period for this amendment will last for 15 days, from September 17, 2021 through October 2, 2021. Written comments will be accepted until 5:00 p.m., October 2, 2021 and can be emailed to JPape@mt.gov or mailed to the addresses below:

Henneberry FAS Proposed Improvement Project
Montana Fish, Wildlife & Parks, Region 3
1400 South 19th Avenue
Bozeman, MT 59718

13. List of Agencies Consulted/Contacted During Preparation of the EA:

- Montana Fish, Wildlife & Parks
- Montana Natural Heritage Program
- State Historic Preservation Office

14. Names, Address, and Phone Number of Project Sponsor:

Jay Pape, FWP Region 3 FAS Manager, 1400 South 19th Avenue, Bozeman, MT 59718, (406) 577-7873

15. Other Pertinent Information:

Henneberry FAS (Beaverhead River mile 70) is the only FAS in the 6-mile stretch between Pipe Organ FAS (river mile 67.5) and High Bridge FAS (river mile 73) and is a heavily used site for boating, floating, fishing, picnicking, wildlife viewing, and walking. Other nearby FWP access opportunities include Bannack State Park, about 18 miles from Henneberry FAS; Clark's Lookout State Park in Dillon; Poindexter Slough FAS; and Corrals FAS. FWP obtained a concurrence from the Montana State Historic Preservation Office (SHPO) that there is a low likelihood of adverse impacts to cultural resources (**Appendix**) resulting from construction of the proposed project. If cultural materials are discovered during construction, work would cease and SHPO would be contacted for a more in-depth investigation. The Beaverhead River in the vicinity of Henneberry FAS is an active channel and several active flood channels cross the FAS property.

PART II. IDENTIFICATION OF THE PREFERRED ALTERNATIVES

Alternative A, the Proposed Alternative, and Alternative B, the No Action Alternative, were considered.

- **Alternative A (Proposed Alternative)** is as described in Part I, paragraph 9 (Description of Project), to expand the parking facilities and improve the staging area roads, boat ramps, and ADA-accessibility on Henneberry FAS. There are beneficial consequences to acceptance of the **Proposed Alternative**.
- **Alternative B (No Action Alternative)** Under the No Action Alternative, the expansion of the parking facilities and improvements to Henneberry FAS would not occur and the area would remain as an active FAS without the proposed improvements. The No Action Alternative would have no significant or potentially negative environmental impacts or consequences. The FAS would continue to operate under the present conditions and the land use on the adjacent land would remain the same.

Description and analysis of reasonable alternatives (including the no action alternative) to the proposed action whenever alternatives are reasonably available and prudent to consider and a discussion of how the alternatives would be implemented: Only the proposed alternative and the no action alternative were considered. There were no other alternatives that were deemed reasonably available, nor prudent. Neither the Proposed Alternative nor the No Action Alternative would have significant negative environmental or potentially negative consequences.

Describe any Alternatives considered and eliminated from Detailed Study:

None. Only the proposed alternative and the no action alternative were considered. There was no other alternative that were deemed reasonably available, or prudent. Neither the **Proposed Alternative** nor the **No Action Alternative** would have significant negative environmental or potentially negative consequences.

List and explain proposed mitigating measures (stipulations): None

PART III. ENVIRONMENTAL REVIEW

Abbreviated Checklist – The degree and intensity of the proposed action determines the extent of Environmental Review. An abbreviated checklist may be used for those projects that are not complex, controversial, or are not in environmentally sensitive areas.

Table 1. Potential impact on physical environment.

Will the proposed action result in potential impacts to:	Unknown	Potentially Significant	Minor	None	Can Be Mitigated	Comments Below
1. Unique, endangered, fragile, or limited environmental resources				X		1
2. Terrestrial or aquatic life and/or habitats				X		2
3. Introduction of new species into an area				X		3
4. Vegetation cover, quantity & quality				X		4
5. Water quality, quantity & distribution (surface or groundwater)				X		5
6. Existing water right or reservation				X		6
7. Geology & soil quality, stability & moisture				X		7
8. Air quality or objectionable odors				X		8
9. Historical & archaeological sites				X		9
10. Demands on environmental resources of land, water, air & energy				X		10
11. Aesthetics				X		11

1. No designated critical habitat for any wildlife species is located near the proposed project. According to the MNHP, observations of bald eagle and peregrine falcon (both listed as DM by the USFWS) have been recorded in the vicinity of the proposed project. No other occurrences of federally ranked, or considered for ranking, animal or plant species have been found within the vicinity of the proposed project.

2. The proposed project would have only minor and short-term impacts on wildlife and native plant species. Resident or transient wildlife may temporarily leave the area during construction but would likely return upon project completion.

3. No new animal or plant species would be introduced to the site as a result of the proposed project.

4. The elimination of vegetation for the construction of the new parking area would not change the overall abundance and diversity of plant species within the area. The proposed project occupies a small portion of the property and the site has been disturbed by heavy recreational use for years. Therefore, the proposed project would have no or minor impact on native vegetation in the area.
5. The proposed project would have minor or no impact on water quality, quantity, and distribution. Construction of a designated parking area may alter surface runoff. However, the Proposed Action would be designed to minimize any effect on surface water, surface runoff, and drainage patterns, and FWP *Best Management Practices* would be followed.
6. The proposed project would have no impact on water rights or reservation.
7. The proposed project would cause limited displacement of soils but the developments would not substantially affect geological features or establish new erosion patterns. Soil disruption during construction would be localized. Erosion control measures would be in effect and the disturbed area would be reseeded.
8. Minor and temporary dust and vehicle emissions would be created by construction equipment during construction. However, the construction time is short and human effects would be limited due to the sparse population near the property.
9. This project uses no federal funds, so the Federal 106 Regulations do not apply. FWP obtained a concurrence from SHPO that it is unlikely that there would be adverse impacts to cultural resources from the proposed project (**Appendix**). If cultural materials are discovered during construction, work would cease and SHPO would be contacted for a more in-depth investigation.
11. Because the area is already used as a FAS and the project area is small, the proposed project would have no additional impact on the aesthetics of the area.

Table 2. Potential impacts on human environment.

Will the proposed action result in potential impacts to:	Unknown	Potentially Significant	Minor	None	Can Be Mitigated	Comments Below
1. Social structures and cultural diversity				X		1
2. Changes in existing public benefits provided by wildlife populations and/or habitat				X		2
3. Local and state tax base and tax revenue				X		3.
4. Agricultural production				X		4
5. Human health				X		5
6. Quantity & distribution of community & personal income				X		
7. Access to & quality of recreational activities		X Positive				7
8. Locally adopted environmental plans & goals (ordinances)				X		
9. Distribution & density of population and housing				X		
10. Demands for government services				X		
11. Industrial and/or commercial activity				X		

- 1.** The proposed project would have no impact on social structures and cultural diversity.
- 2.** The proposed project would have no impact on existing public benefits provided by wildlife populations and/or habitat.
- 3.** The proposed project would have no impact on local and state taxes and tax revenues.
- 4.** Though the FAS is surrounded by agricultural land used for grazing and hay production, the site has not been in agricultural production since 1977.

5. The proposed project would have no impact on human health and would improve public safety.

7. The proposed developments would improve recreational opportunities within the community by increasing parking capacity, improving boat-launching facilities, and improving the ADA-accessibility of the FAS facilities.

PART IV. NARRATIVE EVALUATION AND COMMENT

All of the pertinent or potential impacts of the project have been reviewed, discussed, and analyzed. The proposed project is not complex, controversial, or located in an environmentally sensitive area. The project being implemented is located on an existing FAS or altered areas that together with the insignificant environmental effects of the proposed action, indicates that this should be considered the final version of the environmental assessment. There are no significant environmental or economic impacts associated with the proposed alternative.

PART V. ENVIRONMENTAL CONSEQUENCES

Does the proposed action involve potential risks or adverse effects, which are uncertain but extremely harmful if they were to occur? No

Does the proposed action have impacts that are individually minor, but cumulatively significant or potentially significant? Individually, the proposed actions have minor impacts. However, it was determined that there are no significant or potentially significant cumulative impacts. Cumulative impacts have been assessed considering any incremental impact of the proposed action when they are combined with other past, present, and reasonably foreseeable future actions, and no significant impacts or substantially controversial issues were found. There are no extreme hazards created with this project and there are no conflicts with the substantive requirements of any local, state, or federal law, regulation, standard or formal plan.

Recommendation and justification concerning preparation of EIS:

There are no significant environmental or economic impacts associated with the proposed alternative; therefore, an EIS is not required.

PART VI. EA CONCLUSION SECTION

Individuals or groups contributing to, or commenting on, this EA:

- Jay Pape, Region 3 FAS Manager, 1400 South 19th Ave, Bozeman, MT 59718, (406) 577-7873
- MT Fish Wildlife and Parks

EA prepared by:

Andrea Darling, Darling Natural Resource Consulting, Montana City, MT 59634

Amended EA prepared by:

Jay Pape, FWP Region 3 FAS Manager, Bozeman, MT 59718, (406) 577-7873

Date Completed:

September 17, 2021

Describe public involvement, if any:

This draft EA would be advertised on FWP's web site and through a legal ad in the *Dillon Tribune, Dillon, MT* announcing a public comment period. A press release would also announce the project and comment period.

APPENDIX

FWP.MT.GOV



THE **OUTSIDE** IS IN US ALL.

1522 9th Avenue
P.O. Box 200701
Helena, Montana 59620-0701

Dr. Mark Baumler, SHPO
State Historical Preservation Office
P.O. Box 201202
1301 Lockey Avenue
Helena, Montana 59620-1202

RE: [Henneberry Fishing Access Site Cultural Resource Inventory]

May 22, 2018

Dear Dr. Baumler:

The Department of Fish, Wildlife and Parks (FWP) is proposing development of the Henneberry Fishing Access Site in Beaverhead County. The proposed undertaking is located on lands administered by FWP at approximately T9S R10W Section 15 as indicated in the enclosed report. We request SHPO review of the enclosed inventory, *Cultural Resource Survey: Montana Fish, Wildlife and Parks Henneberry Fishing Access Site, Beaverhead County, Montana* and the eligibility determinations stated below.

FWP believes that the APE, as defined in the enclosed report, adequately considers all reasonable potential effects to Historic Properties from this proposed undertaking. We also believe that the report prepared by David Schwab for FWP is adequate and we agree with his methods. We agree with the consultant's recommendations of eligibility and that, due to the low likelihood of adverse impacts to cultural resources, the site development should be allowed to proceed as proposed.

We request your concurrence on the adequacy of the enclosed report and the low likelihood of adverse impacts to cultural resources. Please feel free to contact Bardell Mangum at (406) 841-4012 or by e-mail at bmangum@mt.gov if you have any questions or concerns regarding the proposed project.

Sincerely,

Bardell Mangum, PLA
Landscape Architect
Design & Construction

Encl.: Unbound hard copy of report; CRABS form
cc: File 448.3; Ray Heagney (FWP)

2018052208
RECEIVED

MAY 22 2018

BY: SHPO

STAN
FWP/FKH

CONCUR
MONTANA SHPO
DATE 5/24/18 SIGNED [Signature]

RECEIVED

MAY 29 2018

DESIGN & CONSTRUCTION
DEPT. OF FISH, WILDLIFE & PARKS