

Pyramid Lake

Bathymetry Survey Map

MONTANA FWP

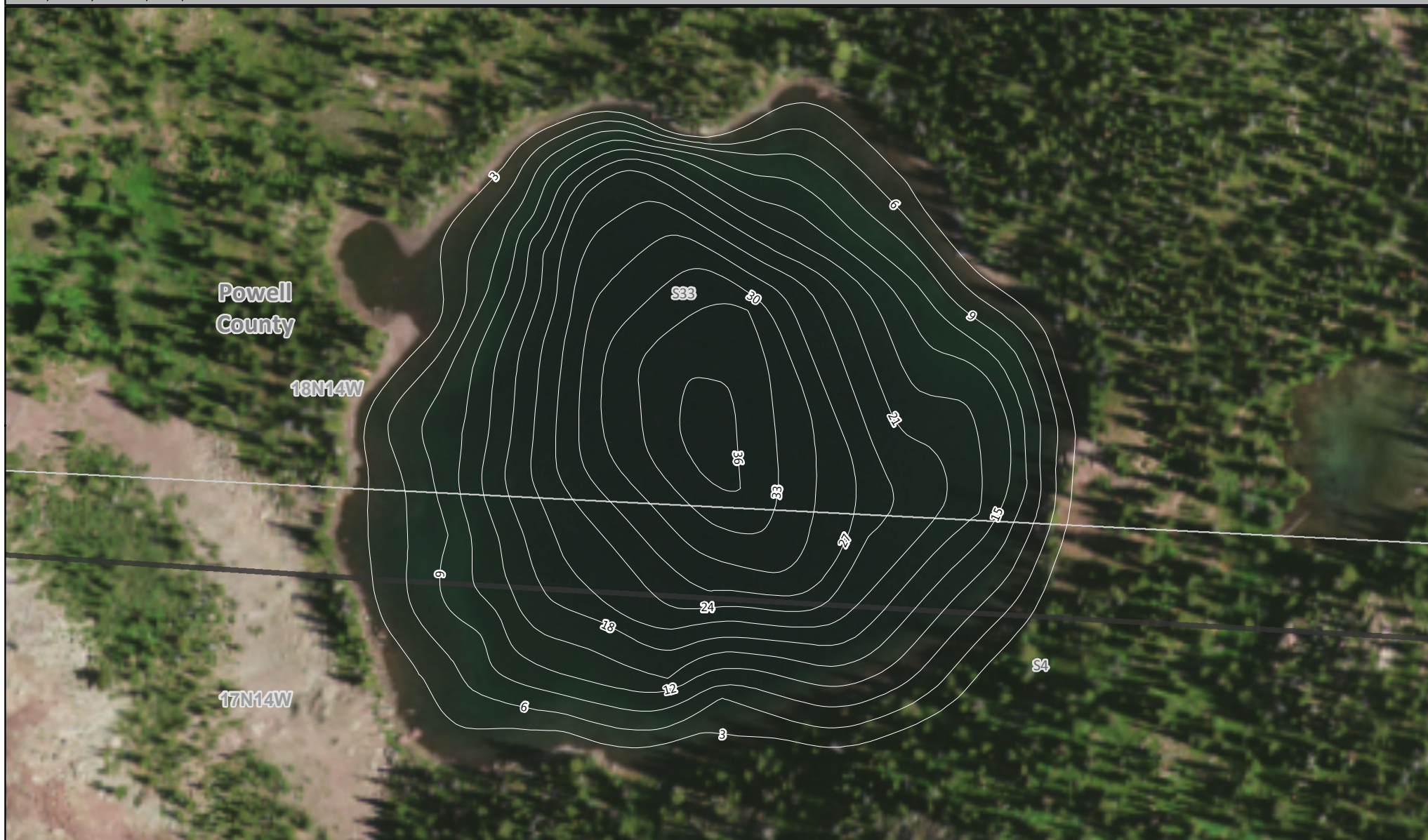

Elevation: 6992 Feet
Area: 9 Acres
Max Depth: 37 Feet
Volume: 190 Acre-Feet
Ave Depth: 21 Feet



Map Produced by: Geographic Data Services Section Date: 06/27/2018 Lake levels may change. This map is not suitable for navigation. Lake Mapped on 2013-03-07

Administrative boundaries and FWP Lands data from Montana Fish, Wildlife & Parks, Helena, MT. Other data from Montana State Library, Helena, MT. Background Imagery from USDA Aerial Photography Field Office, 2015

0 0.015 0.03
Miles